

# Catalogue Supplement 2017.

Valve technology. By SCHELL.

---

Regulating angle valve COMFORT  
with filter, 250 µm



WC operating panel MONTUS CIRCUM



Concealed wall-mounted faucet LINUS W-E-M



Responsibility for health.

---

## eSCHELL. Connect sanitary fittings intelligently.

**eSCHELL** is an intelligent water management system developed by the hygiene experts from SCHELL specically for public sanitary facilities. It allows linking, controlling and monitoring all fittings via the central eSCHELL Water Management Server. It starts with wash basin fittings, shower fittings and on to WC or urinal fittings and covers, e.g. the control of water quantities, stagnation flushes or thermal disinfection.

The special feature: With eSCHELL fittings can be linked both by cable and wireless. What's more: The system can be expanded at any time by additional Water Management Servers each with up to 64 linked fittings.

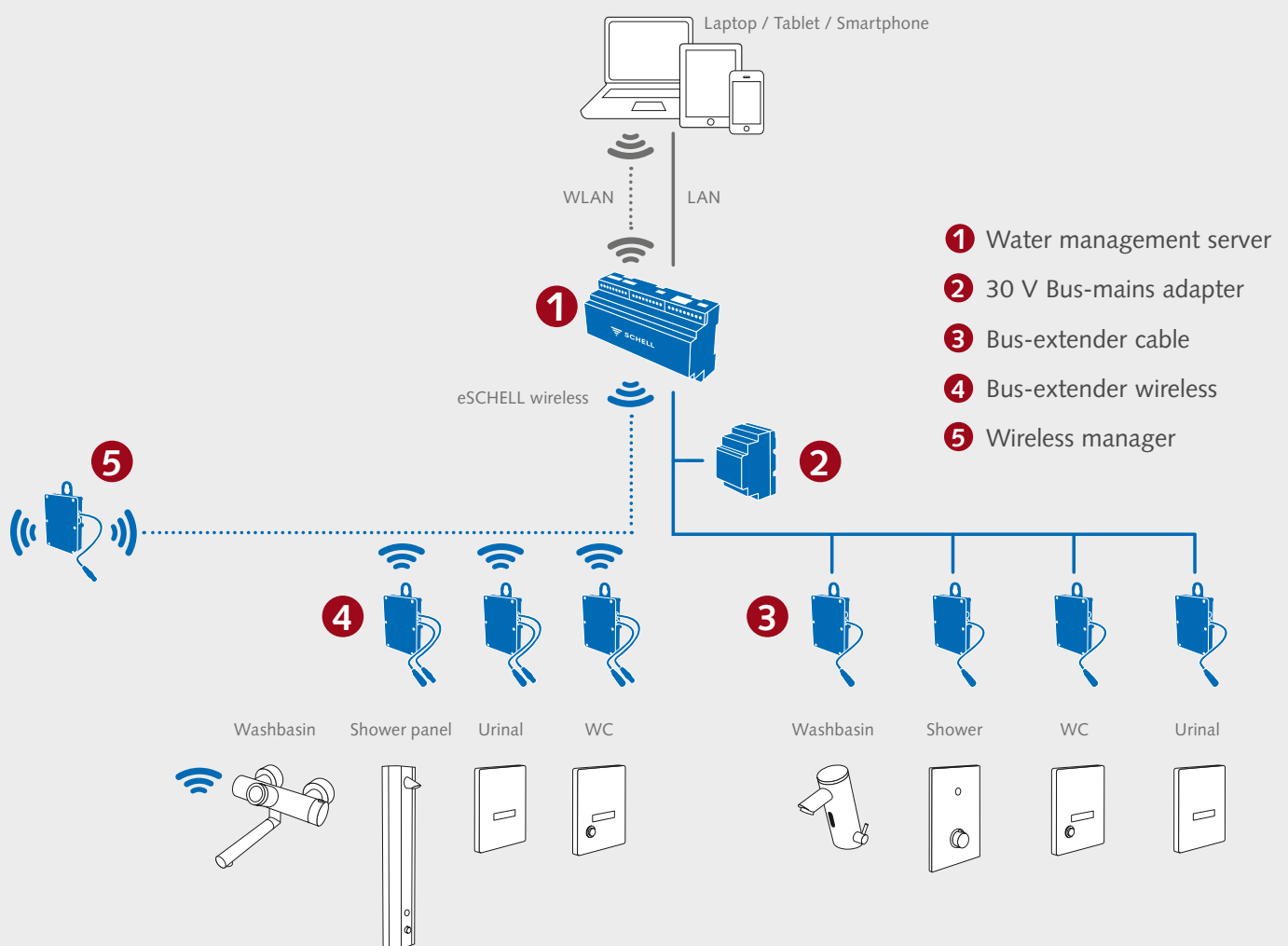

# Contents

Concealed wall-mounted faucets LINUS E	4 - 11
WC flush valve SCHELLOMAT VALUE	12
WC operating panels MONTUS	14 - 16
Draw-off taps, auxiliary connection valves, appliance valves with rosette	17 - 21
Angle valves, special angle valves, inclined-seat valves with rosette	22 - 23
Filter angle valves COMFORT	24
Angle valve COMFORT PT	25
Radiator screw connections	26
General sales, delivery, and payment conditions	28 - 29

---

## Information on eSCHELL.

SWS

**SCHELL water management system:** The suitable products are required for creating a network (wireless or cable) and are marked with this symbol.

SSC

**SCHELL Single Control:** Our fittings with the SSC logo can be parameterized and read out by a point to point connection.

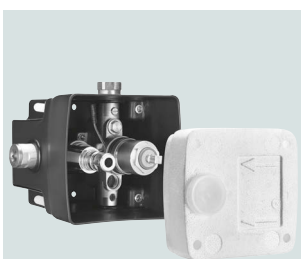

Built-in wall unit Masterbox  
for concealed wall-mounted  
draw-off-taps LINUS W-E-V

available from III. Q. 2017

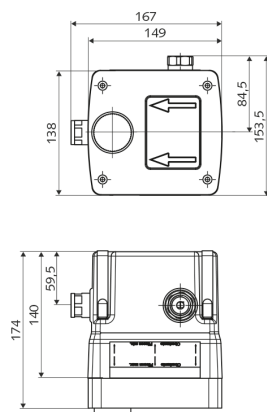

#### Product description

Order  
number

#### SCHELL built-in wall unit Masterbox WBW-E-V

electronic - cold water

built-in wall unit fitting in combination with finishing set for wall taps, fitting pre-assembled in plastic built-in wall box with sealed housing bushings

#### Comprises:

- electronic solenoid valve 6 V
- outlet adapter
- isolating valve
- pre-filter
- backflow preventer (BP, DIN EN 1717: EB)
- flow-through connection piece
- fastening material and flush-mounted cap

#### Use / Technical data:

- flow rate:  $\leq 15,0$  l/min with 3 bar flow pressure
- flow pressure: 1,5 - 5,0 bar
- hot water temperature max. 70 °C (short-time use)
- dimensions: 149 mm x 138 mm x 140 mm
- installation depth: 100 - 124 mm, water connect. G 1/2 int. thread

**Material:** water path out of dezincification-resistant brass conform German drinking water regulation

PU 1

01 947 00 99



#### Required associated items:

- for dry wall installation splash-proof adhesive flange 01 857 00 99 page 1.31 (catalogue 2016/2017) or
- Wall-mounted faucet LINUS W-E-V  
01 937 06 99, 01 938 06 99, 01 939 06 99,  
01 937 28 99, 01 938 28 99, 01 939 28 99 page 5 or  
01 940 06 99, 01 941 06 99, 01 942 06 99,  
01 940 28 99, 01 941 28 99, 01 942 28 99 page 6 or  
01 943 06 99, 01 944 06 99, 01 945 06 99,  
01 943 28 99, 01 944 28 99, 01 945 28 99 page 7





SWS

SSC

available from III. Q. 2017

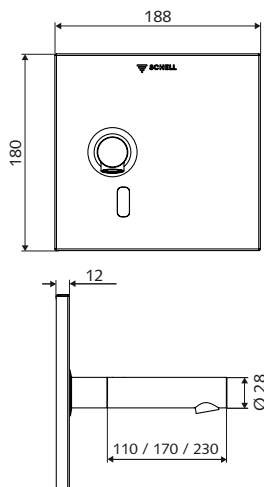

## Product description

Order  
number

**SCHELL wall-mounted faucet LINUS W-E-V**

Infrared sensor electronic - cold water, battery operation

suitable for networking with SWS, parametrisable by SSC  
wall-mounted finishing set for built-in wall unit Masterbox  
WBW-E-V with straight outlet

**Comprises:**

- front panel 180 mm x 188 mm x 12 mm
- electronic module programmable
- battery compartment
- 4 x AA alkaline battery
- mounting frame with fastening material
- wall outlet with jet regulator (theft-safe)

**Use / Technical data:**

- flow regulation independent of pressure max. 5,0 l/min
- flow pressure: 1 - 5 bar
- hot water temperature max. 70 °C (short-time use)
- adjustable by hand programming
  - sensor range short, middle, long
  - stagnation flush programm (permanent flush 30 s, 24 h after last use / every 24 h)
  - flow time permanent flush for thermal disinfection (permanent flush 300 s) / permanent flush 120 s
  - cleaning stop 60 s
- adjustment with eSCHELL-Software
  - max. flow time 1 - 360 s
  - post-run time 0,6 - 60 s
  - stagnation flush time 5 - 600 s
  - stagnation flush intervals 1 - 240 h
  - flow time for thermal disinfection 15 - 600 s
  - permanent flush 15 - 600 s
  - energy-save mode activated 1 - 254 h
  - cleaning stop 60 - 360 s

**Material:** outlet brass conform German drink. water regul.

**110 mm outlet, front panel out of brass**

chrome, PU 1

01 937 06 99

**170 mm outlet, front panel out of brass**

chrome, PU 1

01 938 06 99

**230 mm outlet, front panel out of brass**

chrome, PU 1

01 939 06 99

**110 mm outlet, front panel out of stainless steel**

stainless steel, PU 1

01 937 28 99

**170 mm outlet, front panel out of stainless steel**

stainless steel, PU 1

01 938 28 99

**230 mm outlet, front panel out of stainless steel**

stainless steel, PU 1

01 939 28 99

**Required associated items:**

- built-in wall unit Masterbox WBW-E-V 01 947 00 99 page 4

**Recommended associated items:**

- eSCHELL USB adapter for eSCHELL software 01 586 00 99 page 1.12 (catalogue 2016/2017)



available from III. Q. 2017

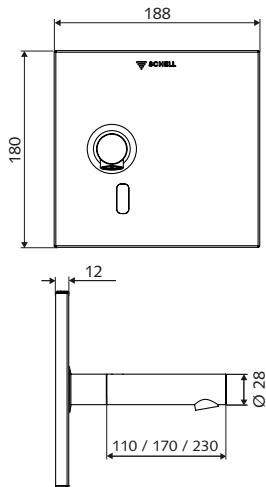

Product description	Order number		
---------------------	--------------	--	--

**SHELL wall-mounted faucet LINUS W-E-V**  
Infrared sensor electronic - cold water, mains operation  
suitable for networking with SWS, parametrisable by SSC  
wall-mounted finishing set for built-in wall unit Masterbox  
WBW-E-V with straight outlet

- Comprises:**
- front panel 180 mm x 188 mm x 12 mm
  - electronic module programmable
  - concealed power supply unit 100 - 240 V, 60 Hz, 9 V
  - mounting frame with fastening material
  - wall outlet with jet regulator (theft-safe)

- Use / Technical data:**
- flow regulation independent of pressure max. 5,0 l/min
  - flow pressure: 1 - 5 bar
  - hot water temperature max. 70 °C (short-time use)
  - adjustable by hand programming
    - sensor range short, middle, long
    - stagnation flush programm (permanent flush 30 s., 24 h after last use / every 24 h)
    - flow time permanent flush for thermal disinfection (permanent flush 300 s) / permanent flush 120 s
    - cleaning stop 60 S
  - adjustment with eSHELL-Software
    - max. flow time 1 - 360 s
    - post-run time 0,6 - 60 s
    - stagnation flush time 5 - 600 s
    - stagnation flush intervals 1 - 240 h
    - flow time for thermal disinfection 15 - 600 s
    - permanent flush 15 - 600 s
    - energy-save mode activated 1 - 254 h
    - cleaning stop 60 - 360 s

**Material:** outlet brass conform German drink. water regul.

<b>110 mm outlet, front panel out of brass</b> chrome, PU 1	01 940 06 99
<b>170 mm outlet, front panel out of brass</b> chrome, PU 1	01 941 06 99
<b>230 mm outlet, front panel out of brass</b> chrome, PU 1	01 942 06 99
<b>110 mm outlet, front panel out of stainless steel</b> stainless steel, PU 1	01 940 28 99
<b>170 mm outlet, front panel out of stainless steel</b> stainless steel, PU 1	01 941 28 99
<b>230 mm outlet, front panel out of stainless steel</b> stainless steel, PU 1	01 942 28 99

-  **Required associated items:**
- built-in wall unit Masterbox WBW-E-V 01 947 00 99 page 4

-  **Recommended associated items:**
- eSHELL USB adapter for eSHELL software 01 586 00 99 page 1.12 (catalogue 2016/2017)



SWS

SSC

available from III. Q. 2017

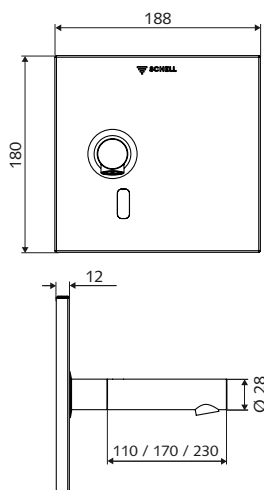

## Product description

Order  
number**SCHELL wall-mounted faucet LINUS W-E-V**

Infrared sensor electronic - cold water

suitable for networking with SWS, parametrisable by SSC  
wall-mounted finishing set for built-in wall unit Masterbox  
WBW-E-V with straight outlet

**Comprises:**

- power supply unit not included in delivery scope
- front panel 180 mm x 188 mm x 12 mm
- electronic module programmable
- mounting frame with fastening material
- wall outlet with jet regulator (theft-safe)

**Use / Technical data:**

- flow regulation independent of pressure max. 5,0 l/min
- flow pressure: 1 - 5 bar
- hot water temperature max. 70 °C (short-time use)
- adjustable by hand programming
  - sensor range short, middle, long
  - stagnation flush programm (permanent flush 30 s, 24 h after last use / every 24 h)
  - flow time permanent flush for thermal disinfection (permanent flush 300 s) / permanent flush 120 s
  - cleaning stop 60 s
- adjustment with eSCHELL-Software
  - max. flow time 1 - 360 s
  - post-run time 0,6 - 60 s
  - stagnation flush time 5 - 600 s
  - stagnation flush intervals 1 - 240 h
  - flow time for thermal disinfection 15 - 600 s
  - permanent flush 15 - 600 s
  - energy-save mode activated 1 - 254 h
  - cleaning stop 60 - 360 s

**Material:** outlet brass conform German drink. water regul.**110 mm outlet, front panel out of brass**

chrome, PU 1

01 943 06 99

**170 mm outlet, front panel out of brass**

chrome, PU 1

01 944 06 99

**230 mm outlet, front panel out of brass**

chrome, PU 1

01 945 06 99

**110 mm outlet, front panel out of stainless steel**

stainless steel, PU 1

01 943 28 99

**170 mm outlet, front panel out of stainless steel**

stainless steel, PU 1

01 944 28 99

**230 mm outlet, front panel out of stainless steel**

stainless steel, PU 1

01 945 28 99

**Required associated items:**

- built-in wall unit Masterbox WBW-E-V 01 947 00 99 page 4
- eSCHELL water management server 00 500 00 99
- eSCHELL Bus mains adapter 30 V 00 505 00 99
- eSCHELL Bus-extender cable BE-K 00 501 00 99

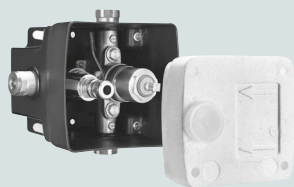

Built-in wall unit Masterbox  
for concealed wall-mounted  
draw-off-taps LINUS W-E-M

available from III. Q. 2017

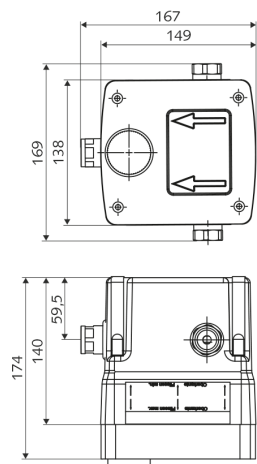

#### Product description

Order  
number

#### SCHELL built-in wall unit Masterbox WBW-E-M

electronic - mixed water

built-in wall unit fitting in combination with finishing set for wall taps, fitting pre-assembled in plastic built-in wall box with sealed housing bushings

#### Comprises:

- electronic solenoid valve 6 V
- mixed cartridge
- outlet adapter
- isolating valve
- pre-filter
- backflow preventer (BP, DIN EN 1717: EB)
- flow-through connection piece
- fastening material and flush-mounted cap

#### Use / Technical data:

- flow rate:  $\leq 15,0$  l/min with 3 bar flow pressure
- flow pressure: 1,5 - 5,0 bar
- hot water temperature max. 70 °C (short-time use)
- dimensions: 149 mm x 138 mm x 140 mm
- installation depth: 100 - 124 mm, water connect. G 1/2 int. thread

**Material:** water path out of dezincification-resistant brass conform German drinking water regulation

PU 1

01 946 00 99



#### Required associated items:

- for dry wall installation splash-proof adhesive flange 01 857 00 99 page 1.31 (catalogue 2016/2017) or
- Wall-mounted faucet LINUS W-E-M 01 928 06 99, 01 929 06 99, 01 930 06 99, 01 928 28 99, 01 929 28 99, 01 930 28 99 page 9 or 01 931 06 99, 01 932 06 99, 01 933 06 99, 01 931 28 99, 01 932 28 99, 01 933 28 99 page 10 or 01 934 06 99, 01 935 06 99, 01 936 06 99, 01 934 28 99, 01 935 28 99, 01 936 28 99 page 11



SWS

SSC

available from III. Q. 2017

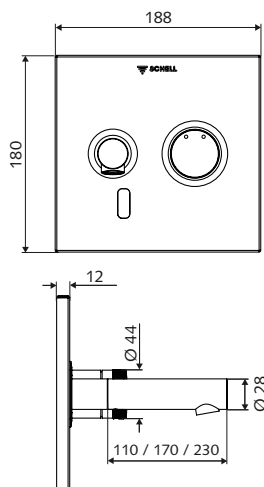

## Product description

Order  
number

**SCHELL wall-mounted faucet LINUS W-E-M**

Infrared sensor electronic - mixed water, battery operation

suitable for networking with SWS, parametrisable by SSC  
wall-mounted finishing set for built-in wall unit Masterbox  
WBW-E-M with straight outlet

**Comprises:**

- front panel 180 mm x 188 mm x 12 mm
- electronic module programmable
- operation knob mixed-water with slip-on bushing
- battery compartment
- 4 x AA alkaline battery
- mounting frame with fastening material
- wall outlet with jet regulator (theft-safe)

**Use / Technical data:**

- flow regulation independent of pressure max. 5,0 l/min
- flow pressure: 1 - 5 bar
- hot water temperature max. 70 °C (short-time use)
- adjustable by hand programming
  - sensor range short, middle, long
  - stagnation flush programm (permanent flush 30 s, 24 h after last use / every 24 h)
  - flow time permanent flush for thermal disinfection (permanent flush 300 s) / permanent flush 120 s
  - cleaning stop 60 s
- adjustment with eSCHELL-Software
  - max. flow time 1 - 360 s
  - post-run time 0,6 - 60 s
  - stagnation flush time 5 - 600 s
  - stagnation flush intervals 1 - 240 h
  - flow time for thermal disinfection 15 - 600 s
  - permanent flush 15 - 600 s
  - energy-save mode activated 1 - 254 h
  - cleaning stop 60 - 360 s

**Material:** operation, slip-on bushing and push rod out of brass  
chromed, outlet out of brass conform German drinking water  
regulation

**110 mm outlet, front panel out of brass**

chrome, PU 1

01 928 06 99

**170 mm outlet, front panel out of brass**

chrome, PU 1

01 929 06 99

**230 mm outlet, front panel out of brass**

chrome, PU 1

01 930 06 99

**110 mm outlet, front panel out of stainless steel**

stainless steel, PU 1

01 928 28 99

**170 mm outlet, front panel out of stainless steel**

stainless steel, PU 1

01 929 28 99

**230 mm outlet, front panel out of stainless steel**

stainless steel, PU 1

01 930 28 99

**Required associated items:**

- built-in wall unit Masterbox WBW-E-M 01 946 00 99 page 8

**Recommended associated items:**

- eSCHELL USB adapter for eSCHELL software 01 586 00 99  
page 1.12 (catalogue 2016/2017)



SWS

SSC

available from III. Q. 2017

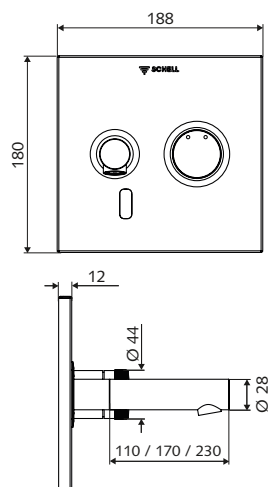

## Product description

Order  
number

**SCHELL wall-mounted faucet LINUS W-E-M**

Infrared sensor electronic - mixed water, mains operation

suitable for networking with SWS, parametrisable by SSC  
wall-mounted finishing set for built-in wall unit Masterbox  
WBW-E-M with straight outlet

**Comprises:**

- front panel 180 mm x 188 mm x 12 mm
- electronic module programmable
- operation knob mixed-water with slip-on bushing
- concealed power supply unit 100 - 240 V, 60 Hz, 9 V
- mounting frame with fastening material
- wall outlet with jet regulator (theft-safe)

**Use / Technical data:**

- flow regulation independent of pressure max. 5,0 l/min
- flow pressure: 1 - 5 bar
- hot water temperature max. 70 °C (short-time use)
- adjustable by hand programming
  - sensor range short, middle, long
  - stagnation flush programm (permanent flush 30 s, 24 h after last use / every 24 h)
  - flow time permanent flush for thermal disinfection (permanent flush 300 s) / permanent flush 120 s
  - cleaning stop 60 s
- adjustment with eSCHELL-Software
  - max. flow time 1 - 360 s
  - post-run time 0,6 - 60 s
  - stagnation flush time 5 - 600 s
  - stagnation flush intervals 1 - 240 h
  - flow time for thermal disinfection 15 - 600 s
  - permanent flush 15 - 600 s
  - energy-save mode activated 1 - 254 h
  - cleaning stop 60 - 360 s

**Material:** outlet brass conform German drink. water regul.

**110 mm outlet, front panel out of brass**

chrome, PU 1

01 931 06 99

**170 mm outlet, front panel out of brass**

chrome, PU 1

01 932 06 99

**230 mm outlet, front panel out of brass**

chrome, PU 1

01 933 06 99

**110 mm outlet, front panel out of stainless steel**

stainless steel, PU 1

01 931 28 99

**170 mm outlet, front panel out of stainless steel**

stainless steel, PU 1

01 932 28 99

**230 mm outlet, front panel out of stainless steel**

stainless steel, PU 1

01 933 28 99

**Required associated items:**

- built-in wall unit Masterbox WBW-E-M 01 946 00 99 page 8

**Recommended associated items:**

- eSCHELL USB adapter for eSCHELL software 01 586 00 99 page 1.12 (catalogue 2016/2017)



SWS

SSC

available from III. Q. 2017

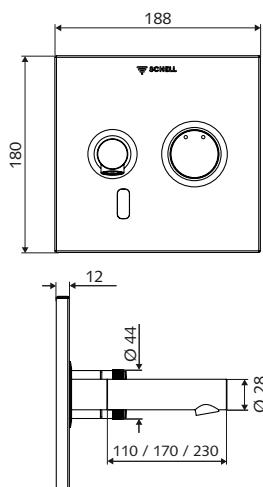

## Product description

Order  
number**SHELL wall-mounted faucet LINUS W-E-M**

Infrared sensor electronic - mixed water

suitable for networking with SWS, parametrisable by SSC  
wall-mounted finishing set for built-in wall unit Masterbox  
WBW-E-M with straight outlet

**Comprises:**

- power supply unit not included in delivery scope
- front panel 180 mm x 188 mm x 12 mm
- electronic module programmable
- operation knob mixed-water with slip-on bushing
- mounting frame with fastening material
- wall outlet with jet regulator (theft-safe)

**Use / Technical data:**

- flow regulation independent of pressure max. 5,0 l/min
- flow pressure: 1 - 5 bar
- hot water temperature max. 70 °C (short-time use)
- adjustable by hand programming
  - sensor range short, middle, long
  - stagnation flush programm (permanent flush 30 s, 24 h after last use / every 24 h)
  - flow time permanent flush for thermal disinfection (permanent flush 300 s) / permanent flush 120 s
  - cleaning stop 60 s
- adjustment with eSHELL-Software
  - max. flow time 1 - 360 s
  - post-run time 0,6 - 60 s
  - stagnation flush time 5 - 600 s
  - stagnation flush intervals 1 - 240 h
  - flow time for thermal disinfection 15 - 600 s
  - permanent flush 15 - 600 s
  - energy-save mode activated 1 - 254 h
  - cleaning stop 60 - 360 s

**Material:** outlet brass conform German drink. water regul.**110 mm outlet, front panel out of brass**

chrome, PU 1

01 934 06 99

**170 mm outlet, front panel out of brass**

chrome, PU 1

01 935 06 99

**230 mm outlet, front panel out of brass**

chrome, PU 1

01 936 06 99

**110 mm outlet, front panel out of stainless steel**

stainless steel, PU 1

01 934 28 99

**170 mm outlet, front panel out of stainless steel**

stainless steel, PU 1

01 935 28 99

**230 mm outlet, front panel out of stainless steel**

stainless steel, PU 1

01 936 28 99

**Required associated items:**

- built-in wall unit Masterbox WBW-E-M 01 946 00 99 page 8
- eSHELL water management server 00 500 00 99
- eSHELL Bus mains adapter 30 V 00 505 00 99
- eSHELL Bus-extender cable BE-K 00 501 00 99

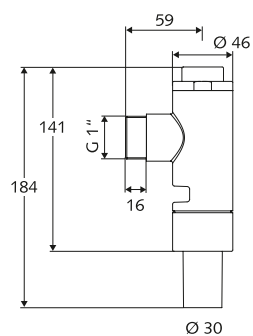
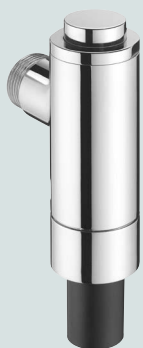

## Product description

Order  
number**SCHELL WC flush valve SCHELLOMAT VALUE**

for low pressure, DN 25

with pushbutton for single flush, high flush capacity.

Robust all-metal flush valve unit, all visible parts out of brass.

Flush unit with anti-vacuum device according to DIN EN 12451.

**Use / Technical Data:**

- Flow pressure: 0,4 - 2,5 bar
- Flush: 1 - 1,3 l/s
- Flush volume: 6 l
- Flush pipe connection 30 x 32 mm

**Material:**

- All visible components out of brass DIN EN,  
Functional parts cartridge plastic

Dimension: DN 25 G 1 ext. thread,  
chrome, PU 1, W: 0,82 kg/pc.

02 254 06 99





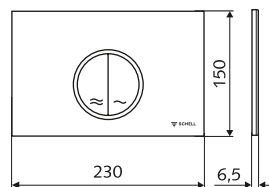
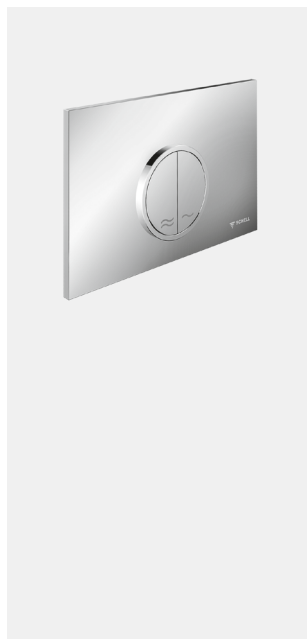

## Product description

Order  
number

## SCHELL WC operating panel MONTUS CIRCUM

dual flush

Material: ABS

chrome, PU 1

03 119 06 99

matt chrome, PU 1

03 119 64 99

white, PU 1

03 119 15 99



## Required associated items:

- WC module MONTUS (Type C 120) 03 056 00 99 page 2.25 (catal. 2016/ 2017) or
- WC module MONTUS (Type C 120) 03 057 00 99 page 2.25 (catal. 2016/ 2017) or
- WC module MONTUS (Type C 80) 03 062 00 99 page 2.26 (catal. 2016/ 2017) or
- WC module MONTUS (Type C 120 NF) 03 066 00 99 page 2.27 (catal. 2016/ 2017) or
- WC module MONTUS (Type 820 C) 03 060 00 99 page 2.27 (catal. 2016/ 2017) or
- WC module MONTUS (Type C 90) 03 061 00 99 page 2.28 (catal. 2016/ 2017) or
- WC module MONTUS (Type C-N 120) 03 058 00 99 page (catal. 2016/ 2017) 2.29 or
- WC module MONTUS (Type C-N 80) 03 059 00 99 page (catal. 2016/ 2017) 2.29 or
- WC module MONTUS (Type C 80 n) 03 064 00 99 page 2.30 (catal. 2016/ 2017)

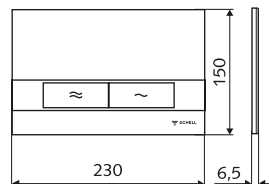
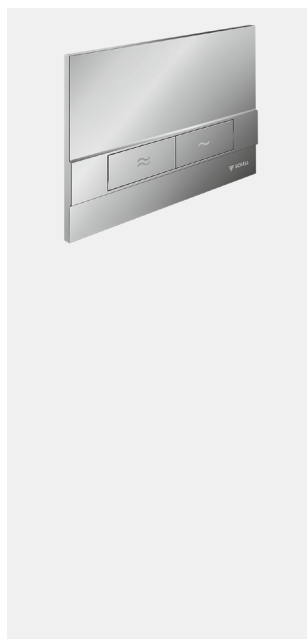

## SCHELL WC operating panel MONTUS BOARD

dual flush

Material: ABS

chrome, PU 1

03 120 06 99

matt chrome, PU 1

03 120 64 99

white, PU 1

03 120 15 99



## Required associated items:

- WC module MONTUS (Type C 120) 03 056 00 99 page 2.25 (catal. 2016/ 2017) or
- WC module MONTUS (Type C 120) 03 057 00 99 page 2.25 (catal. 2016/ 2017) or
- WC module MONTUS (Type C 80) 03 062 00 99 page 2.26 (catal. 2016/ 2017) or
- WC module MONTUS (Type C 120 NF) 03 066 00 99 page 2.27 (catal. 2016/ 2017) or
- WC module MONTUS (Type 820 C) 03 060 00 99 page 2.27 (catal. 2016/ 2017) or
- WC module MONTUS (Type C 90) 03 061 00 99 page 2.28 (catal. 2016/ 2017) or
- WC module MONTUS (Type C-N 120) 03 058 00 99 page (catal. 2016/ 2017) 2.29 or
- WC module MONTUS (Type C-N 80) 03 059 00 99 page (catal. 2016/ 2017) 2.29 or
- WC module MONTUS (Type C 80 n) 03 064 00 99 page 2.30 (catal. 2016/ 2017)

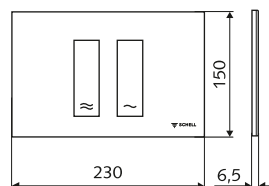
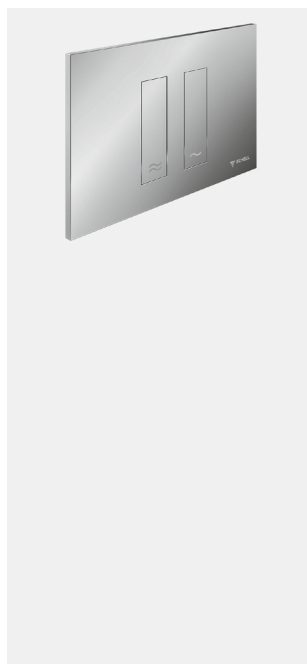

## SCHELL WC operating panel MONTUS TOWER

dual flush

Material: ABS

chrome, PU 1

03 121 06 99

matt chrome, PU 1

03 121 64 99

white, PU 1

03 121 15 99



## Required associated items:

- WC module MONTUS (Type C 120) 03 056 00 99 page 2.25 (catal. 2016/ 2017) or
- WC module MONTUS (Type C 120) 03 057 00 99 page 2.25 (catal. 2016/ 2017) or
- WC module MONTUS (Type C 80) 03 062 00 99 page 2.26 (catal. 2016/ 2017) or
- WC module MONTUS (Type C 120 NF) 03 066 00 99 page 2.27 (catal. 2016/ 2017) or
- WC module MONTUS (Type 820 C) 03 060 00 99 page 2.27 (catal. 2016/ 2017) or
- WC module MONTUS (Type C 90) 03 061 00 99 page 2.28 (catal. 2016/ 2017) or
- WC module MONTUS (Type C-N 120) 03 058 00 99 page (catal. 2016/ 2017) 2.29 or
- WC module MONTUS (Type C-N 80) 03 059 00 99 page (catal. 2016/ 2017) 2.29 or
- WC module MONTUS (Type C 80 n) 03 064 00 99 page 2.30 (catal. 2016/ 2017)

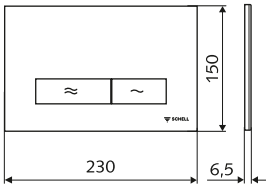

Product description	Order number		
---------------------	--------------	--	--

**SCHELL WC operating panel MONTUS KONKAV**  
dual flush

Material: ABS

chrome, PU 1	03 122 06 99
matt chrome, PU 1	03 122 64 99
white, PU 1	03 122 15 99



- Required associated items:**
- WC module MONTUS (Type C 120) 03 056 00 99 page 2.25 (catal. 2016/ 2017) or
  - WC module MONTUS (Type C 120) 03 057 00 99 page 2.25 (catal. 2016/ 2017) or
  - WC module MONTUS (Type C 80) 03 062 00 99 page 2.26 (catal. 2016/ 2017) or
  - WC module MONTUS (Type C 120 NF) 03 066 00 99 page 2.27 (catal. 2016/ 2017) or
  - WC module MONTUS (Type 820 C) 03 060 00 99 page 2.27 (catal. 2016/ 2017) or
  - WC module MONTUS (Type C 90) 03 061 00 99 page 2.28 (catal. 2016/ 2017) or
  - WC module MONTUS (Type C-N 120) 03 058 00 99 page (catal. 2016/ 2017) 2.29 or
  - WC module MONTUS (Type C-N 80) 03 059 00 99 page (catal. 2016/ 2017) 2.29 or
  - WC module MONTUS (Type C 80 n) 03 064 00 99 page 2.30 (catal. 2016/ 2017)

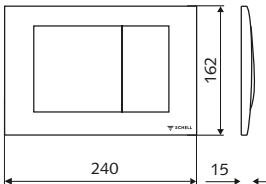

**SCHELL WC operating panel MONTUS FIELD**  
vandal resistant zinc diecast model, dual flush

Material: zinc diecast

chrome, PU 1	03 126 06 99
matt chrome, PU 1	03 126 64 99



- Required associated items:**
- WC module MONTUS (Type C 120) 03 056 00 99 page 2.25 (catal. 2016/ 2017) or
  - WC module MONTUS (Type C 120) 03 057 00 99 page 2.25 (catal. 2016/ 2017) or
  - WC module MONTUS (Type C 80) 03 062 00 99 page 2.26 (catal. 2016/ 2017) or
  - WC module MONTUS (Type C 120 NF) 03 066 00 99 page 2.27 (catal. 2016/ 2017) or
  - WC module MONTUS (Type 820 C) 03 060 00 99 page 2.27 (catal. 2016/ 2017) or
  - WC module MONTUS (Type C 90) 03 061 00 99 page 2.28 (catal. 2016/ 2017) or
  - WC module MONTUS (Type C-N 120) 03 058 00 99 page (catal. 2016/ 2017) 2.29 or
  - WC module MONTUS (Type C-N 80) 03 059 00 99 page (catal. 2016/ 2017) 2.29 or
  - WC module MONTUS (Type C 80 n) 03 064 00 99 page 2.30 (catal. 2016/ 2017)

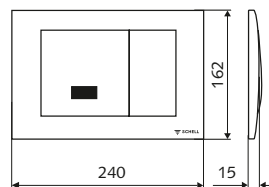

## Product description

Order  
number**SCHELLWC operating panel MONTUS FIELD E**

vandal resistant zinc diecast model, dual flush,  
infrared actuation/manual actuation in case of power failure  
possible  
accessory for SCHELL concealed cisterns

**Comprises:**

- transformer 230 V / 12 V 50 Hz
- front panel with electronic

**Use / Technical Data::**

- hygienic flush 24h after last use

**Material:** zinc diecast

chrome, PU 1

03 123 06 99

**Required associated items:**

**Electronic conversion kit 03 125 00 99 for WC operating panel FIELD E in combination with a 8 cm cistern**

- WC module MONTUS (Type C 80) 03 062 00 99 page 2.26 (catal. 2016/ 2017) or
- WC module MONTUS (Type C 90) 03 061 00 99 page 2.28 (catal. 2016/ 2017) or
- WC module MONTUS (Type C-N 80) 03 059 00 99 page 2.29 (catal. 2016/ 2017) or
- WC module MONTUS (Type C 80 n) 03 064 00 99 page 2.30 (catal. 2016/ 2017)

**Electronic conversion kit 03 127 00 99 for WC operating panel FIELD E in combination with a 12 cm cistern**

- WC module MONTUS (Type C 120) 03 056 00 99, 03 057 00 99 page 2.25 (catal. 2016/ 2017) or
- WC module MONTUS (Type C 120 NF) 03 066 00 99 page 2.27 (catal. 2016/ 2017) or
- WC module MONTUS (Type C-N 120) 03 058 00 99 page 2.29 (catal. 2016/ 2017)

**SCHELL Electronic conversion kit MONTUS**

for WC operating panel FIELD E in combination with a 8 cm  
concealed cistern

**Comprises:**

- crane motor incl. fixture
- outlet bell

PU 1

03 125 00 99

**Required associated items:**

- WC operating panel MONTUS FIELD E page 16

**Mounting instruction:**

According to cistern depth (8 or 12 cm) the corresponding electronic retrofit set has to be used. A combination with the WC module MONTUS (Type 820 C) is not possible.

**SCHELL Electronic conversion kit MONTUS**

for WC operating panel FIELD E in combination with a 12 cm  
concealed cistern

**Comprises:**

- crane motor incl. fixture

PU 1

03 127 00 99

**Required associated items:**

- WC operating panel MONTUS FIELD E page 16

**Mounting instruction:**

According to cistern depth (8 or 12 cm) the corresponding electronic retrofit set has to be used. A combination with the WC module MONTUS (Type 820 C) is not possible.



New: with rosette  
available from III. Q. 2017

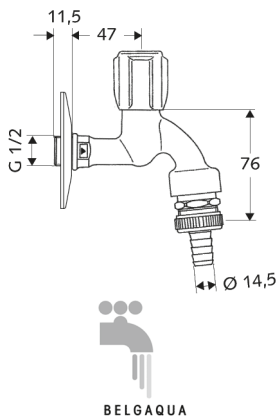

Product description	Order number		
---------------------	--------------	--	--

**SCHELL COMFORT draw-off tap**  
with COMFORT handle and grease chamber head part

- Comprises:**
- rosette Ø 54 mm
  - backflow preventer (BP) and anti-vacuum device in flow form (AVD)
  - hose screw connection

**Use / Technical Data:**

- safety combination in accordance with EN 1717

**Material:** brass conform German drinking water regulation

**Noise Class:** I by 100 % flush volume

**Test Mark:** PA-IX 28171/I, DVGW certified, Belgaqua

**Dimension:** DN 15 G 1/2 ext. thread, chrome, PU 1, W: 0.38 kg/pc.

03 351 06 99



New: with rosette  
available from III. Q. 2017

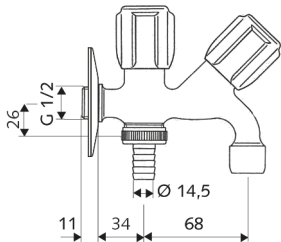

**SCHELL COMFORT combination draw-off tap**  
with COMFORT handle and grease chamber head part

- Comprises:**
- rosette Ø 54 mm
  - hose screw connection
  - aerator

**Material:** brass conform German drinking water regulation

**Dimension:** DN 15 G 1/2 ext. thread, chrome, PU 1, W: 0.48 kg/pc.

03 562 06 99

EB



New: with rosette  
available from III. Q. 2017

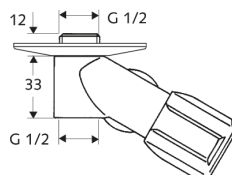
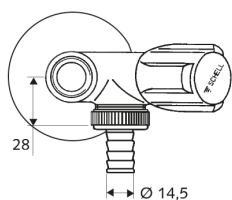

## Product description

Order  
number

**SCHELL COMFORT AC valve**

for single tap points

auxiliary connection valve for single tap point with COMFORT handle and grease chamber head part

**Comprises:**

- rosette Ø 54 00
- backflow preventer (BP)
- hose screw connection

**Use / Technical Data:**

- in combination with the anti-vacuum device complies with the requirements of EN 1717 safety combination

HD

**Material:** brass conform German drinking water regulation

**Noise Class:** II

**Test Mark:** PA-IX 2852/II

**Dimension:** DN 15 G 1/2 ext. thread x G 1/2 int. thread, chrome, PU 1, W: 0.36 kg/pc.

03 309 06 99



**Recommended associated item:**

- anti-vacuum device 28 602 06 99 page 3.14 (cat. 2016/2017)

HD

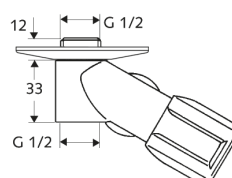
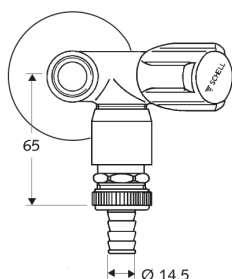

New: with rosette  
available from III. Q. 2017

**SCHELL COMFORT AC valve**

for single tap points

auxiliary connection valve for single tap points with COMFORT handle and grease chamber head part

**Comprises:**

- rosette Ø 54 mm
- backflow preventer (BP) and anti-vacuum device in flow form (AVD)
- hose screw connection

**Use / Technical Data:**

- safety combination in accordance with EN 1717

**Material:** brass conform German drinking water regulation

**Test Mark:** DVGW certified, Belgaqua

**Dimension:** DN 15 G 1/2 ext. thread x G 1/2 int. thread, chrome, PU 1, W: 0.50 kg/pc.

03 313 06 99



BELGAQUA



New: with rosette  
available from III. Q. 2017

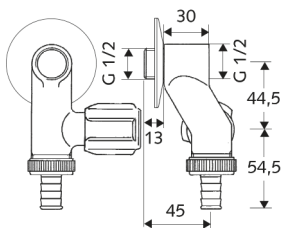

## Product description

**SCHELL COMFORT AC valve**  
for hot water appliances  
with COMFORT handle and grease chamber head part

### Comprises:

- rosette Ø 54 mm
- backflow preventer (BP, DIN EN 1717: EB)
- hose screw connection

### Use / Technical Data:

- wall distance: 30 mm

**Material:** brass conform German drinking water regulation

**Dimension:** DN 15 G 1/2 ext. thread x G 1/2 int. thread, chrome, PU 1, W: 0.32 kg/pc.

03 316 06 99



HD



New: with rosette  
available from III. Q. 2017

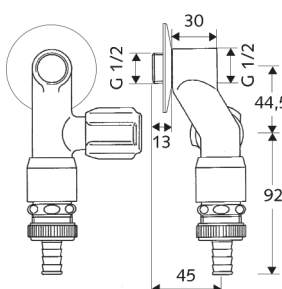

## SCHELL COMFORT AC valve

for hot water appliances

wall distance: 30 mm  
with COMFORT handle and graease chamber head part

### Comprises:

- rosette Ø 54 mm
- hose screw connection
- backflow preventer (BP) and anti-vacuum device in flow form (AVD)

### Use / Technical Data:

- safety combination in accordance with EN 1717

**Material:** brass conform German drinking water regulation

**Test Mark:** DVGW certified

**Dimension:** DN 15 G 1/2 ext. thread x G 1/2 int. thread, chrome, PU 1, W: 0.46 kg/pc.

03 318 06 99

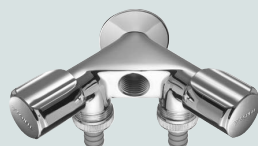

New: with rosette  
available from III. Q. 2017

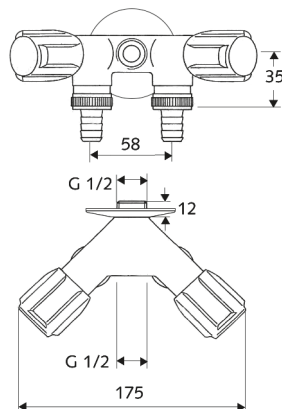

## SCHELL COMFORT AC double valve

with two hose connections and G 1/2 int. thread

with 2 COMFORT handles and grease chamber head parts

### Comprises:

- rosette Ø 54 mm
- 2 backflow preventers (BP, DIN EN 1717: EB)
- 1 internal thread G 1/2
- 2 hose screw connections

**Material:** brass conform German drinking water regulation

**Dimension:** DN 15 G 1/2 ext. thread, chrome, PU 1, W: 0.74 kg/pc.

03 368 06 99



EB

New: with rosette  
available from III. Q. 2017

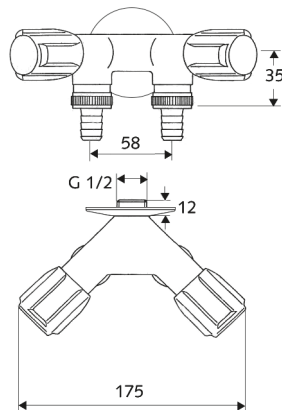

## SCHELL COMFORT AC double valve

with two hose connections

with 2 COMFORT handles and grease chamber head parts

### Comprises:

- rosette Ø 54 mm
- 2 backflow preventers (BP, DIN EN 1717: EB)
- without internal thread
- 2 hose screw connections

**Material:** brass conform German drinking water regulation

**Dimension:** DN 15 G 1/2 ext. thread, chrome, PU 1, W: 0.79 kg/pc.

03 366 06 99



### Recommended associated item:

- anti-vacuum device 28 602 06 99 page 3.14 (cat. 2016/2017)

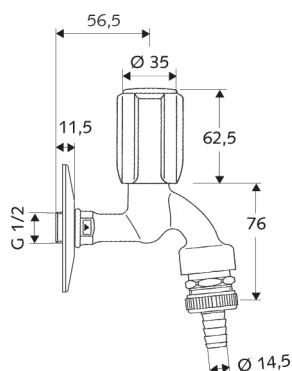
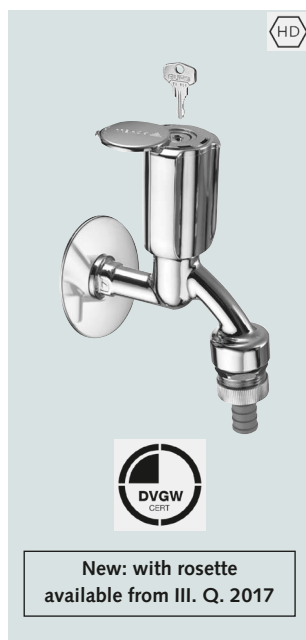

## Product description

Order number

## Product group 31

**SCHELL SECUR draw-off tap**

lockable sanitary handle, against unauthorised access to water supply

Model: COMFORT

**Comprises:**

- rosette Ø 54 mm
- grease chamber head part
- 2 keys
- backflow preventer (BP) and anti-vacuum device in flow form (AVD)
- hose screw connection

**Use / Technical Data:**

- prevents unauthorised access to water supply
- safety combination in accordance with EN 1717

Material: brass conform German drinking water regulation

Noise Class: I at 100 % flush volume

Test Mark: PA-IX 28171/I, DVGW certified, Belgaqua

Dimension: DN 15 G 1/2 ext. thread, chrome, PU 1, W: 0.39 kg/pc

03 352 06 99

**Mounting instruction:**

Several fittings with identical key on application

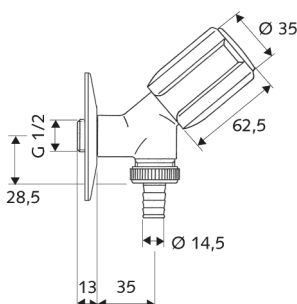
**SCHELL SECUR inclined-seat valve**

lockable sanitary handle against unauthorised access to water supply

Model: COMFORT

**Comprises:**

- rosette Ø 54 mm
- grease chamber head part
- 2 keys
- backflow preventer (BP, DIN EN 1717: EB)
- hose screw connection

Material: brass conform German drinking water regulation

Dimension: DN 15 G 1/2 ext. thread, chrome, PU 1, W: 0.41 kg/pc.

03 387 06 99

**Mounting instruction:**

Several fittings with identical key on application

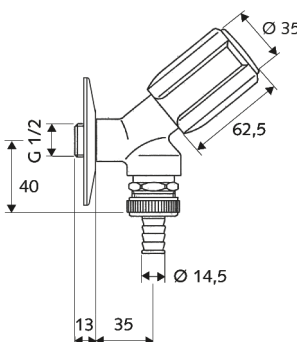
**SCHELL SECUR inclined-seat valve**

lockable sanitary handle against unauthorised access to water supply

Model: COMFORT

**Comprises:**

- rosette Ø 54 mm
- grease chamber head part
- 2 keys
- backflow preventer (BP) and anti-vacuum device in flow form (AVD)
- hose screw connection

**Use / Technical Data:**

- prevents unauthorised access to water supply
- safety combination in accordance with EN 1717

Material: brass conform German drinking water regulation

Noise Class: I

Test Mark: P-IX 007/I, DVGW certified

Dimension: DN 15 G 1/2 ext. thread, chrome, PU 1, W: 0.42 kg/pc.

03 388 06 99

**Mounting instruction:**

Several fittings with identical key on application



EB



New: with rosette  
available from III. Q. 2017

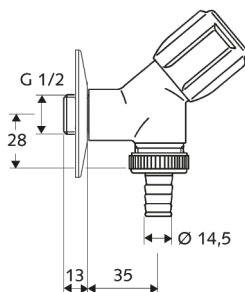

## Product description

Order  
number**SCHELL COMFORT inclined-seat valve**

with COMFORT handle und grease chamber head part

**Comprises:**

- rosette Ø 54 mm
- backflow preventer (BP, DIN EN 1717: EB)
- hose screw connection

**Material:** brass conform German drinking water regulation**Dimension:** DN 15 G 1/2 ext. thread,  
chrome, PU 1, W: 0.37 kg/pc.

03 386 06 99

HD

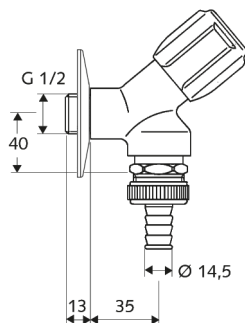

New: with rosette  
available from III. Q. 2017

**SCHELL COMFORT inclined-seat valve**

with COMFORT handle and grease chamber head part

**Comprises:**

- rosette Ø 54 mm
- backflow preventer (BP) and  
anti-vacuum device in flow form (AVD)
- hose screw connection

**Use / Technical Data:**

- safety combination in accordance with EN 1717

**Material:** brass conform German drinking water regulation**Test Mark:** PA-IX 007/I, DVGW certified, Belgaqua**Dimension:** DN 15 G 1/2 ext. thread,  
chrome, PU 1, W: 0.38 kg/pc.

03 392 06 99



EB

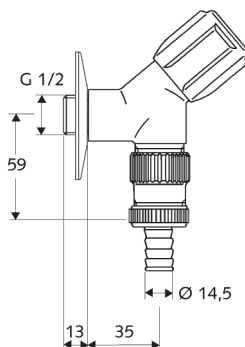

New: with rosette  
available from III. Q. 2017

**SCHELL COMFORT inclined-seat valve**

with COMFORT handle and grease chamber head part

**Comprises:**

- rosette Ø 54 mm
- backflow preventer (BP, DIN EN 1717: EB)
- integrated hose-burst protection
- hose screw connection

**Material:** brass conform German drinking water regulation**Dimension:** DN 15 G 1/2 ext. thread,  
chrome, PU 1, W: 0.44 kg/pc.

03 390 06 99

**Mounting instruction:**shut-off functions in case of slipping or bursting of the hose, for flow rates of more  
than 18 l/min.



geprüft nach  
DIN 3227

New: with rosette  
available from III. Q. 2017

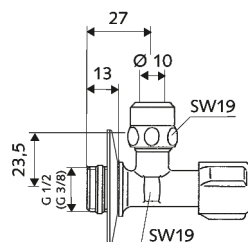

#### Product description

Order  
number

#### SCHELL regulating angle valve COMFORT

DIN regulating angle valve with COMFORT handle

##### Comprises:

- rosette Ø 54 mm
- pull-resistant SCHELL brass cone compression connection with length compensation

##### Use / Technical Data:

- flow class A

**Material:** brass conform German drinking water regulation

**Test Mark:** P-IX 212/IA

##### With self-sealing connection thread (ASAG easy).

**Test Mark:** DVGW certified

**Dim.:** DN 10 G 3/8 ext. thread x DN 10 G 3/8 ext. thread, chrome, PU 50, W: 0.10 kg/pc.

**Dim.:** DN 15 G 1/2 ext. thread x DN 10 G 3/8 ext. thread, chrome, PU 50, W: 0.11 kg/pc.

##### Without self-sealing connection thread.

**Test Mark:** DVGW certified

**Dim.:** DN 10 G 3/8 ext. thread x DN 10 G 3/8 ext. thread, chrome, PU 50, W: 0.10 kg/pc.

##### With self-sealing connection thread (ASAG easy) and KIWA test mark

**Dim.:** DN 10 G 3/8 ext. thread x DN 10 G 3/8 ext. thread, chrome, PU 50, W: 0.10 kg/pc.

##### Without self-sealing connection thread.

**Test Mark:** DVGW certified

**Dim.:** DN 15 G 1/2 ext. thread x DN 10 G 3/8 ext. thread, chrome, PU 50, W: 0.11 kg/pc.



04 911 06 99



04 912 06 99



04 902 06 99



05 097 06 99

04 903 06 99



New: with rosette  
available from III. Q. 2017

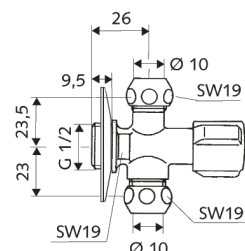

#### SCHELL angle valve COMFORT

With two G 3/8 ext.thread outlets for Ø 10 mm copper pipe

##### Comprises:

- rosette Ø 54 mm
- COMFORT handle
- two compression connections

**Material:** brass conform German drinking water regulation

##### Dimension:

**DN 15 G 1/2 ext. thread x DN 10 G 3/8 ext. thread, chrome, PU 10, W: 0.13 kg/pc.**

04 991 06 99



New: with rosette  
available from III. Q. 2017

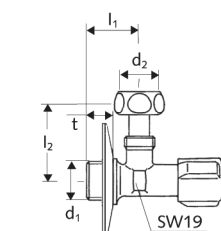

#### SCHELL regulating angle valve COMFORT

DIN regulating angle valve with adjustable screw connection with COMFORT handle

##### Use / Technical Data:

- rosette Ø 54 mm
- for overhead cisterns
- flow class A

**Material:** brass conform German drinking water regulation

**Test Mark:** P-IX 212/IA

##### outlet union nut DN 10 G 3/8

**Dim.:** DN 10 G 3/8 ext. thread x DN 10 G 3/8 int. thread, chrome, PU 50, W: 0.10 kg/pc.

05 033 06 99

**Dim.:** DN 15 G 1/2 ext. thread x DN 10 G 3/8 int. thread, chrome, PU 50, W: 0.11 kg/pc.

05 034 06 99

Order number	DN	d <sub>1</sub>	d <sub>2</sub>	l <sub>1</sub>	t	l <sub>2</sub>
05 033	10	G 3/8	G 3/8	27	13	38
05 034	15	G 1/2	G 3/8	27	13	38



New: with rosette  
available from III. Q. 2017

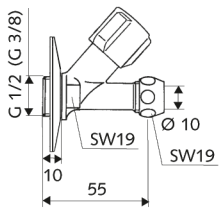

kiwa

Product description	Order number		
<b>SCHELL inclined-seat valve COMFORT</b>			
<b>Comprises:</b> <ul style="list-style-type: none"><li>• rosette Ø 54 mm</li><li>• COMFORT handle</li><li>• compression screw connection</li></ul>			
<b>Use / Technical Data:</b> <ul style="list-style-type: none"><li>• connection: external thread</li><li>• flow class A</li></ul>			
<b>Material:</b> brass conform German drinking water regulation			
<b>Test Mark:</b> PA-IX 216/IA			
<b>kiwa</b> <u>KIWA test mark</u> Dim.: DN 10 G 3/8 ext. thread x DN 10 G 3/8 ext. thread, chrome, PU 50, W: 0.10 kg/pc.			
	05 900 06 99		
<u>Without KIWA test mark</u> Dim.: DN 15 G 1/2 ext. thread x DN 10 G 3/8 ext. thread, chrome, PU 50, W: 0.11 kg/pc.			
	05 901 06 99		



with filter

New: with rosette  
available from III. Q. 2017

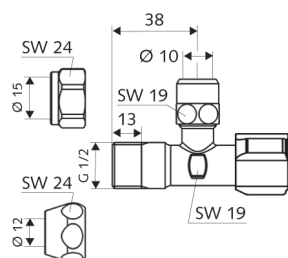

## Product description

Order  
number**SCHELL Regulating angle valve COMFORT with filter**  
connection brass compression fitting**Comprises:**

- filter, mesh size: 250 µm
- pull-resistant SCHELL brass cone compression connection with length compensation
- 1 brass compression connection G 1/2 IG x Ø 12 mm
- 1 brass compression connection G 1/2 IG x Ø 15 mm

**Use / Technical Data:**

- for protection of high-quality fittings, f. ex. electronically controlled fittings
- flow class A

**Test Mark:** P-IX 198/IA

Dim.: DN 15 G 1/2 ext. thread x DN 10 G 3/8 ext. thread,  
chrome, PU 1

05 432 06 99



with filter

New: with rosette  
available from III. Q. 2017

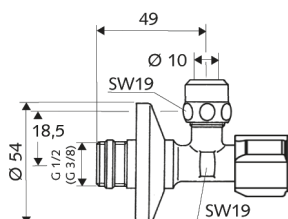
**Regulating angle valve COMFORT with filter****Comprises:**

- filter, mesh gauge: 250 µm
- long push rod, push rosette Ø 54 mm
- pull-resistant SCHELL brass cone compression connection with length compensation

**Use / Technical Data:**

- for the protection of high-quality fittings, for example electronically controlled fittings
- flow class A

**Material:** brass conform German drinking water regulation**Test Mark:** PA-IX 198/IA**With self-sealing connection thread (ASAG easy).**

Dim.: DN 15 G 1/2 ext. thread x DN 10 G 3/8 ext. thread,  
chrome, PU 60

05 428 06 99

**Without self-sealing connection thread**

Dim.: DN 10 G 3/8 ext. thread x DN 10 G 3/8 ext. thread,  
chrome, PU 1

05 429 06 99

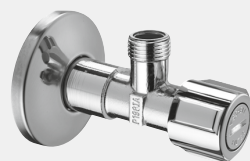

with filter

New: with rosette  
available from III. Q. 2017

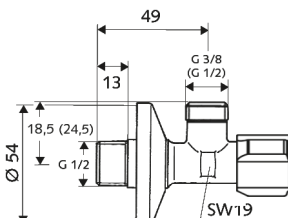
**SCHELL Regulating angle valve COMFORT with filter****Comprises:**

- filter, mesh gauge: 250 µm
- long push rod, push rosette Ø 54 mm
- for flat gasket without compression connection

**Use / Technical Data:**

- For the protection of high-quality fittings, for example electronically controlled fittings
- flow class A

**Material:** brass conform German drinking water regulation**Test Mark:** PA-IX 198/IA

Dim.: DN 15 G 1/2 ext. thread x DN 10 G 3/8 ext. thread,  
chrome, PU 60, G: 0,18 kg/St.

05 430 06 99

Dim.: DN 15 G 1/2 ext. thread x DN 15 G 1/2 ext. thread,  
chrome, PU 1

05 431 06 99

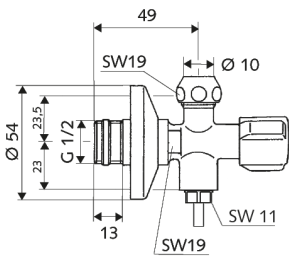
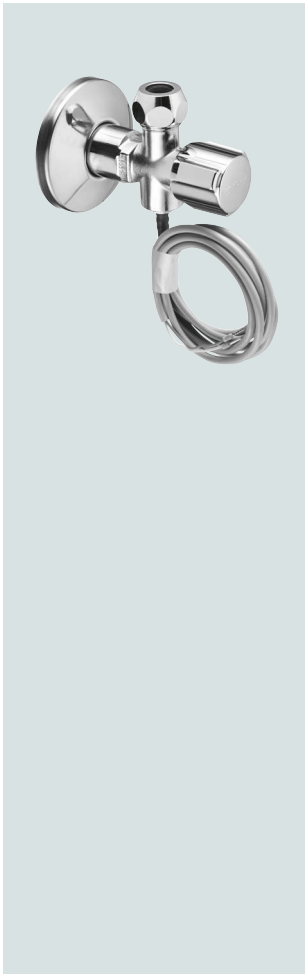

Product description	Order number		
---------------------	--------------	--	--

**SCHELL angle valve COMFORT PT**  
with PT 1000 temperature control

- Comprises:**
- PT 1000 temperature control 1 m, 2 x 0,14 mm<sup>2</sup>
  - self-sealing connection thread (**ASAG easy**)
  - COMFORT handle
  - long push rod, push rosette Ø 54 mm
  - pull-resistant SCHELL brass cone compression with length compensation
  - 4 plastic clips for mounting of sensor cable on connection hose of tap

**Use / Technical Data:**

- PT 1000 temperature control for connection to SCHELL water management system, flow class A

**Material:** brass conform German drinking water regulation

**Noise class:** I

**Test Mark:** P-IX 212/IA

**Dimension:**  
DN 15 G 1/2 ext. thread x DN 10 G 3/8 ext. thread,  
chrome, UE 50, G: 0,16 kg/pc.

04 992 06 99

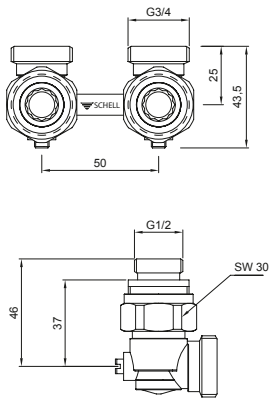

Product description

Order  
number

Double connection valve

For valve radiators with G 1/2 internal thread

Angle Type / capable of being shut off

Use / Technical Data:

- for copper and steel pipe as well as for installation systems with G 3/4 Euro cone internal thread
- radiator connection with G 3/4 external thread x G 1/2 external thread reduction nipple with seal

Material: brass DIN EN

Dimension: DN 15,  
matt nickel, PU 1, W: 0.45 kg/pc.

14 200 04 99

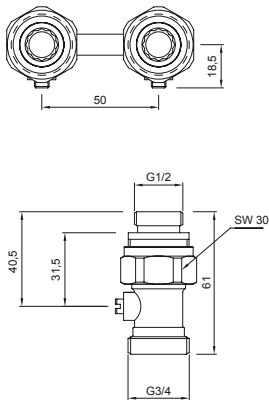

Double connection valve

For valve radiators with G 1/2 internal thread

Straight-through Type / capable of being shut off

Use / Technical Data:

- for copper pipe and steel pipe as well as installation systems with Euro cone G 3/4 internal thread
- radiator connection with reduction nipple G 3/4 external thread x G 1/2 external thread with seal

Material: brass DIN EN

Dimension: DN 15,  
matt nickel, PU 1, W: 0.38 kg/pc.

14 201 04 99

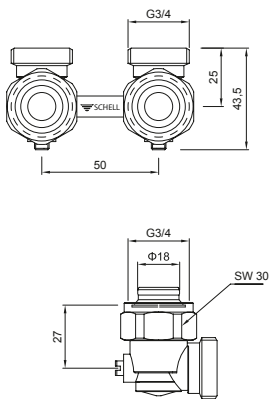

Double connection valve

For valve radiators with G 3/4 external thread

Angle Type / capable of being shut off

Use / Technical Data:

- for copper and steel pipe as well as for installation systems with G 3/4 internal thread Euro cone
- radiator connection with G 3/4 external thread cone adapter

Material: brass DIN EN

Dimension: DN 15,  
matt nickel, PU 1, W: 0.40 kg/pc.

14 202 04 99

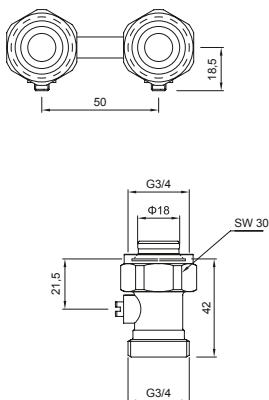

Double connection valve

For valve radiators with G 3/4 external thread

Straight-through Type / capable of being shut off

Use / Technical Data:

- for copper and steel pipe as well as for installation systems with G 3/4 internal thread Euro cone
- radiator connection with G 3/4 external thread cone adapter

Material: brass DIN EN

Dimension: DN 15,  
matt nickel, PU 1, W: 0.33 kg/pc.

14 203 04 99

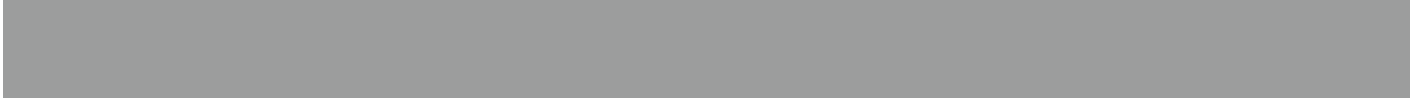

Lined writing area with horizontal grey lines.



# General Sales, Delivery and Payment Conditions of SCHELL GmbH & Co. KG Armaturentechnologie

## I. Standard Conditions, Conclusion of Contract

1. For all quotations, deliveries, and payments the following conditions exclusively apply. Conflicting business and/or purchasing conditions have no validity, even if we do not expressly contradict them. With the placing of an order and/or the receipt of delivery the purchaser recognizes our conditions.
2. The order is obligatory for us with our written endorsement or with the beginning of execution of the order. All agreements met between us and the purchaser in regard to execution of the present contract, are put into writing in the present contract.
3. We can refuse the execution of given orders without declaration of reasons.

## II. Quotation, Cost Estimate, Prices, Price Adjustment Provision

1. Our quotations as well as the prices and delivery availabilities indicated in our catalogs, printed matter, letters etc. are subject to confirmation; cost estimations are non-binding.
2. All orders will only be accepted based on the valid prices at the time of the order. Our prices are to be understood in EUROS, excluding customised special packaging, freight, tariff, plus the respective value added tax. With delivery of goods beyond EURO 500,00 the prices apply free of all charges from receiving station and/or German border.
3. With all orders - also with orders on call and successive delivery contracts - whose delivery according to contract or at the request of the purchaser takes place later than four months after the placement of the order, we are entitled to compute the applicable prices on the day of delivery.
4. For the smallest orders within the EU under a net invoice value of EURO 50,00, we compute a pro rated handling fee of EURO 5,00 for each small order. Orders for replacement parts are excluded from this rule. In non-EU states handling charges as well as the minimum order quantity conform to the shipping and administrative burdens for the respective country.

## III. Shipment, Costs, Passing of Risk

1. Our deliveries take place principally from the Olpe facility at the purchaser's risk. With customer pick-ups the risk passes over to the customer when the goods leave the warehouse. We are not liable - also not with freight-paid delivery - for damages or losses during transport. If nothing else is agreed upon, we decide on the type of packaging and the shipping.
2. If delivery is delayed because of conditions that we do not have to assume responsibility for, the risk passes over to the purchaser from the day that the purchaser has communicated himself ready to take delivery.

## IV. Change of Delivery Item

We reserve the right to construction and form changes as well as changes to the scope of the delivery as long as the goods are not significantly changed and the change is reasonable for the customer. The compliance of measurements, weights, and depictions is nonbinding for us.

## V. Payment Conditions and Consequences for Non-compliance, Set-off

1. Within the EU our bills are payable postage and expense-free within 30 days of admittance of our bill or equivalent itemisation of an amount receivable, at the latest, however, 30 days after maturity and receipt of return service. Afterwards we calculate annual interest at a level of 8 %- points (with private consumers 5 %) above the respective basic interest rate. With payments within 14 days of the date of invoice the purchaser is entitled to deduct 2 % cash discount, with payments within 8 days of the date of invoice, 3 % cash discount, provided that all previous payments have been paid. In non-EU states the individual agreements met with the respective customer apply.
2. We accept changes and checks only against fulfillment of a debt, changes only according to a special agreement. The payment applies first after redemption of the changes or checks as performed. Discount and charges are borne by the purchaser. Independent of the duration of changes taken or granted extensions, our demands become immediately due if the purchaser does not abide by the payment conditions or circumstances become known that place his credit worthiness in doubt. In such a case we are further entitled to only carry out deliveries against payment in advance or by way of surety bond or to withdraw after appropriate respite from the contract and/or to require compensation.
3. Payments to our representative with a liberating effect may only take place if he is invested with an adequate power to collect and the power to collect is confirmed to the purchaser by us in writing.
4. In the face of our conditions the purchaser can only set off with indisputable or established, legally-valid counterclaims.

## VI. Terms of Delivery and Liability Regulations, Obligation of Acceptance, Returns

1. The delivery time begins as soon as all details of performance, especially the technical questions, are clarified and both parties agree about all conditions of the affair. The delivery date is adhered to, if the article of sale had left our factory prior to its expiration, or readiness for shipment was communicated to the purchaser. Adherence to the delivery date presupposes the fulfillment of the contractual obligations of the purchaser, especially the agreed-upon payment conditions.
2. Delivery time information takes place according to our best knowledge, is approximately binding, and can diverge from the actual delivery.
3. If our delivery takes place neither by the due date nor within an additional period established from us to the purchaser for specified reasons, the purchaser is entitled to withdraw in respect to the appointed delivery.

4. For claims for damages because of belated fulfillment or nonfulfillment instead of performance the following applies: If in the attempt to deliver we are, in terms of which only our simple negligence meets, the claim of the purchaser to compensation of damages due to delay, proven by him, is limited to the amount 0,5 % for every full week of delay up to a total amount of 5 % of the value of the bill affected from the delay of the order. If the purchaser can demand compensation for damages instead of performance, we adhere to the purchase of a private consumer (§ 13 BGB) with an injury from the primary obligations of the contract - these obligations are those that, if violated, put the actual purpose of the contract at risk, and the fulfillment of complied with - including in the event of ordinary negligence for damage compensation, however any claims for compensation are limited to the foreseeable damage at the time of contract conclusion.
5. Higher power or circumstances for which we are not responsible (e.g. interruption of operations or strike) and the resulting hindrance of performance of the contract in regard to the deadline entitle us to reasonably postpone the fulfillment of assumed obligations or, if performance thereby becomes impossible for us, to withdraw entirely or in part from the contract. The same applies if materials were required by us from our suppliers for the completion of the order, and the materials ordered out from us, for reasons for which we are not responsible, were not received in time. A condition of the withdrawal is that we inform the purchaser immediately of the unavailability and refund eventual return services of the purchaser immediately. Claims of damages in any form are precluded.
6. Teillieferungen sowie Mehr- oder Minderlieferungen sind grundsätzlich zulässig, es sei denn, dass dies vom Kunden ausdrücklich als nicht zulässig im Auftrag schriftlich niedergeschrieben worden ist.
6. Partial deliveries as well as excess or short deliveries are principally allowable, unless this is expressly noted in the order in text form (Article 126 b German Civil Code / BGB) by the customer as not allowable.
7. In cases of a default in taking delivery by the purchaser we can refuse further delivery and/or demand compensation of the damage.
8. Blanket and make-and-hold orders must be called within 8 months, whereby the delivery time may not exceed three months. With noncompliance of these terms by the purchaser the right pertains to us to either cancel the order and demand compensation because of noncompliance or to bring and calculate the back-ordered goods for shipment.
9. Returns of goods or the cancellation of orders require our written agreement. For all returns of goods - they take place principally at the risk of the sender - we deduct from the conferred credit memo min. 20 % of the net value of the goods for handling charges. Special designs and goods that are no longer contained in our delivery program will not be taken back.

## VII. Notices of Defects, Claims of Defects, Liability Regulations

1. Without prejudice those with a mutual commercial transaction composing continuing examination obligations and obligations to give notice of defects (§ 377 HGB), the purchaser has to examine the delivered goods for visible defects and to notify us in writing of complaints because of such visible defects - that applies also for incomplete or incorrect deliveries - within 5 working days of receiving the goods and with such defects that first become visible at a later time, within 5 working days of recognition by the purchaser in text form (Article 126 b German Civil Code / BGB); otherwise the goods are considered, in view of the visible defect, as approved and the purchaser can insofar exercise no further rights against us. That does not apply with a direct purchase by a private consumer.
2. With entitled notices of defects we are obligated to the cost-free amendment of the delivered goods and/or, according to our choice, to the replacement delivery. With purchases by a private consumer, unless direct or by subcontractor in the delivery chain, the consumer and/or the subcontractor is entitled to the right to choose. If the amendment or replacement delivery fails in spite of two attempts or we refuse this unwarrantedly or we delay this unreasonably, the purchaser is entitled to reduction of the payment, or if there is not a construction capacity article of the warranty for defects, according to his choice, to demand cancellation of the contract.
3. For claims of damages subject to the regulation in VII the following applies: With purchase by a private consumer, unless direct or by subcontractor in the delivery chain, we are liable for an injury from the primary obligations of the contract, also with simple negligence, to compensation for damages instead of performance, however eventual claims to the compensation are limited to foreseeable damages at the time of the conclusion of contract, as long as the defect is not secretly fraudulent or a guarantee for the properties and conditions of the thing have been assumed. Subject to the provision in Clause VIII the following applies to claims for damages: In the event of breaches of essential contractual duties even due to ordinary negligence we assume liability for damages instead of performance, however, the possible claims for compensation are limited to the damages that are foreseeable at the time of the conclusion of the Agreement, unless we have maliciously concealed the defect or we have issued a guarantee regarding the quality of the object.
4. Defective claims do not exist if the error is to be returned due to an injury from operation, maintenance and installation specifications, improper or inappropriate use, erroneous or careless handling by the purchaser, or natural wear, as well as interventions carried out by the purchaser or third parties to the article of sale. The same applies if SCHELL products are incorrectly assembled, are carelessly handled or handled beyond the scope of usual, or disfunctions lead back to inappropriate equipment, replacement of parts, chemical, electrochemical, or electrical effects. Claims of defects also do not exist if our installation instructions and other technical documentation, which were made accessible to the customer at the time of delivery, were not always precisely followed in whichever way the instructions and recommendations contained within had specified.
5. Only in urgent cases of danger of operational safety, of which we are to be immediately informed, or if we are advised in delay of the removal of the defects,



the purchaser has the right to personally remove or to allow a third party to do so and to request from us appropriate compensation for the costs borne by him.

#### VIII. Other Liability (Limits and Exceptions)

1. Aside from the preceding regulated delay and defect claims we meet the obligation, unless a damage is based on an ordinary or grossly negligent breach of duty on our part or on an intentional or grossly negligent breach or duty by our legal representative all fulfilment subsidiaries, or it concerns damages from an injury to the life, the body, the health, that is based on a negligent breach of duty on our side or on the part of our legal representative or fulfilment subsidiary, or it concerns damages that usually and typically are excluded by a liability insurance of us for appropriate insurable conditions. That applies especially for claims of damages from debts before or with contract conclusion, injury from collateral duty and claims from illegal acts.
2. Claims according to the product liability law and from it remain unaffected by a guarantee.

#### IX. Proprietary Rights

Deliveries take place according to the design or special designations of the purchaser, who carries responsibility for the successes and that the proprietary rights of third parties are not injured.

#### X. Retention of Title

1. We reserve the right of possession of the article of sale (reserved goods), until all of our demands on the purchaser from the business agreement have been settled, excluding the conditions arising in the future, also from simultaneously or later concluded contracts. With running invoices the reserved possession and all rights as collateral for our entire balance condition apply together with interest and costs. With garnishments or other third party interventions the purchaser has to notify us immediately.
2. The purchaser is entitled to process and resell the article of sale in the orderly business routine. This power ends if the purchaser comes into delay of payment, further, with the surrender of payment by the purchaser, or if the opening of composition or insolvency procedure of his assets is requested. He is obligated to resell the conditional item only under retention of title and thereby to ensure that the demands from the resale in accordance with 5 and 6 pass over to us. As far as resale applies, the use of the reserved goods for fulfillment of factory and factory consignment contracts also applies. He is not entitled to other provisions regarding the reserved goods, especially for pledging or security. A transfer of the demands from the passing on of our reserved goods is illegal, unless it deals with a transfer in the way of legitimate factoring of which we are notified and with which the value of the receipts of the factoring exceeds our secured demands. With the credit note of the factoring receipts our demand becomes immediately due.
3. Through processing and handling of the reserved goods the purchaser does not acquire the title to the new item in accordance with § 950 BGB. The handling or reshuffle is made for us, without obligating us. The processed and handled goods count as reserved goods.
4. With handling, consolidation and amalgamation of the reserved goods with other goods we reserve the co-ownership of the new item to the ratio of the invoice value of the reserved goods to the invoice value of the other goods used. If our ownership expires through consolidation, amalgamation, or handling, the purchaser immediately confers to us the entitlement of ownership and expectancy rights of the new asset or of the item in the amount of the invoice value of the reserved goods. In cases of the conversion of the amount of the invoice value of the reserved goods to the invoice value of other used goods, they are held in safekeeping for us. Our rights of co-ownership apply to the reserved goods.
5. The demands of the purchaser from the resell of the reserved goods are to be immediately surrendered to us. They serve in the same amount of security as the reserved goods.
6. If the reserved goods together with other goods are resold by the purchaser, the demand from the resale in the amount of the invoice value of the reserved goods to the other goods is surrendered to us. With the resale of goods, to which we have co-ownership rights in accordance with 4, our co-ownership interest in the proportionate part of the demand is due to us.
7. At our request the purchaser is obligated to give us an exact statement of his demands with name and address of the purchaser, to give the assignation of his known purchaser, and to confer to us all necessary information for assertion of the ceded demands. The purchaser reauthorises us, as long as he is in delay of payment or his pecuniary circumstances worsen, to contact the purchaser from the transfer and to collect the demands ourselves. We can require an examination of the condition of the ceded demands by our representatives by means of the purchaser's accounting. The purchaser has to pass a statement over to us regarding the reserved goods still in existence.
8. If the value of the existing collateral exceeds the secured demands altogether by more than 15 %, we are obligated to the requests of the purchaser as far as the release of collateral according to our choice. As value of the collateral applies with simple and downstream-processed retention of ownership, to which the purchaser refers the goods with us, and with the prolonged retention of ownership of the invoice value, to which the purchaser resells our goods.
9. With changes, checks etc., the payment applies first according to secured redemption by the purchaser as contributed. We only take checks in payment of a debt. Payments that take place against relinquishment of a change issued by us first count as performed when the check and/or change recourse is precluded to us. Irrespective of our further security rights the acknowledged collateral

remains with us until this time is reached.

10. Because of the retention of ownership we can reclaim the article of sale if we are withdrawn from the contract. For withdrawal we are entitled without regard to the further requirements of § 323 BGB from the time in which the purchaser finds himself with the payment to us entirely or partially in debtor's delay, it requires no further setting of deadlines in particular for the exercise of a withdrawal on our part. The same applies with the surrender of payment of the purchaser or if beyond his assets the opening of a composition or insolvency procedure is requested. All arising costs resulting from repossession of the delivery item are borne by the purchaser. We are entitled to freely utilise the revoked delivery item.

#### XI. Place of Fulfillment, Legal Domicile, Applicable Right

1. The place of fulfillment is the place of our delivery facility.
2. For contracts with buyers, legal entities of public law, or public legal fund assets all disputes are to be decided in the courts relevant for our company headquarters. We are also entitled to dispute before the courts situated with our respective contracting parties.
3. For all deliveries and performances, German law applies with the exception of the UN-Convention on Contracts for the Sale of International Goods. The contract language is German. If the contracting parties should avail themselves to another language, the German wording has precedence.

#### XII. Export Agreement

It is considered agreed-upon that the related goods from SCHELL remain exclusively in the European Union. An export from the territory of the European Union requires the expressed agreement from SCHELL. In each case of resale by the purchaser, he is responsible for the adherence in the territory of the European Union, or in respective export countries, to the applicable safety measures for water and/or gas equipment.

#### XIII. Safeguarding Clause

If regulations of these conditions and/or the further agreements should be or become ineffective, then the validity of the contract remains unaffected in all other respects. The contracting parties are obligated to replace the ineffective condition by a regulation of equal economic achievement, if possible.

Status: January 2017

Depictions, measurements, and weights as well as descriptions are non-binding and are subject to technical improvement and change. Reprinting and photo-mechanical reproduction, also in extracts, require our expressed permission. The SCHELL Sales and Delivery Conditions are valid.







SCHELL GmbH & Co. KG  
 Armaturentechnologie  
 Raiffeisenstraße 31  
 57462 Olpe  
 Germany  
 Telefon +49 2761 892-0  
 Telefax +49 2761 892-199  
 info@schell.eu  
 www.schell.eu

